

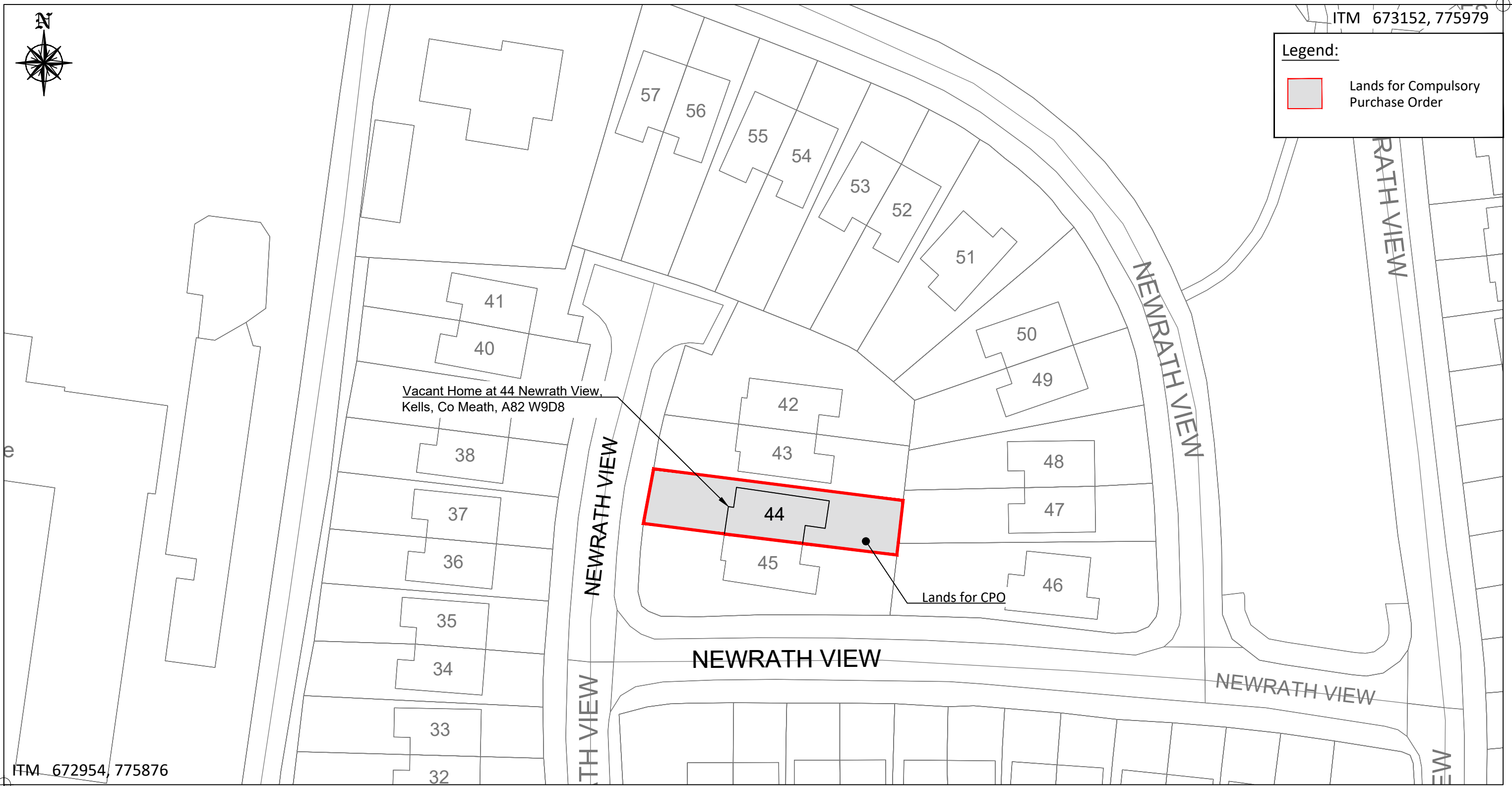

Legend:

Lands for Compulsory Purchase Order



<p><i>This Drawing may contain Third Party Mapping</i></p> <p>© National Mapping Division of Tailte Éireann. All rights reserved. Licence number CYAL50320677/MeathCountyCouncil</p>	<p>Site Address:</p> <p><i>44 Newrath View, Kells, Co Meath, A82 W9D8</i></p>	<p>Area (Ha) = 0.025 Approx</p> <p>Folio Number: MH48953F</p>									
<p>Land to be transferred to MEATH COUNTY COUNCIL is shown lined in RED</p>											
<p>MEATH COUNTY COUNCIL</p> <p>Buvinda House Dublin Rd. Navan, Co.Meath C15 Y291 Tel: (046) 9097000 E-Mail: vacanthomes@meathcoco.ie</p> <p>O.S. Sheet No: 2310-A</p>	<p>Title:</p> <p style="text-align: center;">Compulsory Purchase Order Map Relating to the site referred to as: <i>44 Newrath View, Kells, Co Meath, A82 W9D8</i></p> <p>Drawing Ref: VH-2024-004</p>	<p>Property in the townland(s) of: Town Parks In the county of: Meath</p> <table border="1" style="width: 100%; border-collapse: collapse;"> <tr> <td style="width: 33%;">DRAWN BY: Mark Nilan</td> <td style="width: 33%;">SCALE: 1:500</td> <td style="width: 34%;">Rev:</td> </tr> <tr> <td>CHECKED BY: Yvonne Hyland</td> <td>DATE: November 2024</td> <td>Rev Date:</td> </tr> <tr> <td>APPROVED BY: Pat Shore</td> <td>REF:</td> <td></td> </tr> </table>	DRAWN BY: Mark Nilan	SCALE: 1:500	Rev:	CHECKED BY: Yvonne Hyland	DATE: November 2024	Rev Date:	APPROVED BY: Pat Shore	REF:	
DRAWN BY: Mark Nilan	SCALE: 1:500	Rev:									
CHECKED BY: Yvonne Hyland	DATE: November 2024	Rev Date:									
APPROVED BY: Pat Shore	REF:										